

# STRAIGHTLINE PERFORMANCE

## CAN-AM Defender Backup Beeper Kit

### Installation Manual 282-113

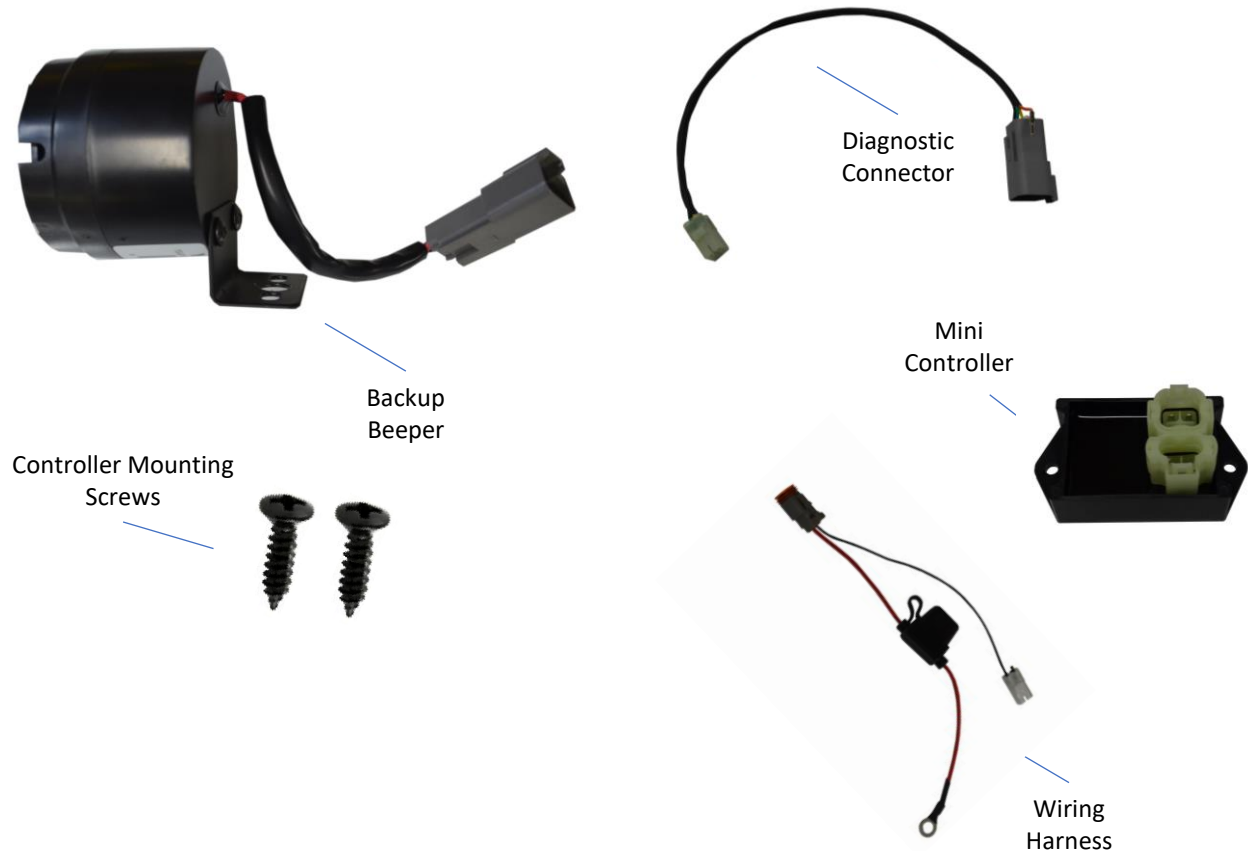

### Required Tools:

Torx T-30
10mm Wrench/Socket
Philips Screwdriver/Bit

Read entire manual before beginning the installation process.

Disclaimer: Straightline Performance is not responsible for any damage due to improper installation.

Straightline Performance backup lights  
[www.Straightlineperformance.com](http://www.Straightlineperformance.com)

CAN-AM Defender Backup Beeper  
[Tech@straightlineperformance.com](mailto:Tech@straightlineperformance.com)

# Step 1: Secure and Plug-in Controller

- 1) Remove diagnostic connector from housing under the front dash panel and plug connector into mini controller.
- 2) Secure controller with provided mounting screws; if necessary, drill 1/16" pilot hole.

**Note:** Refer to page 4 for explanation of diagnostic connector assembly.

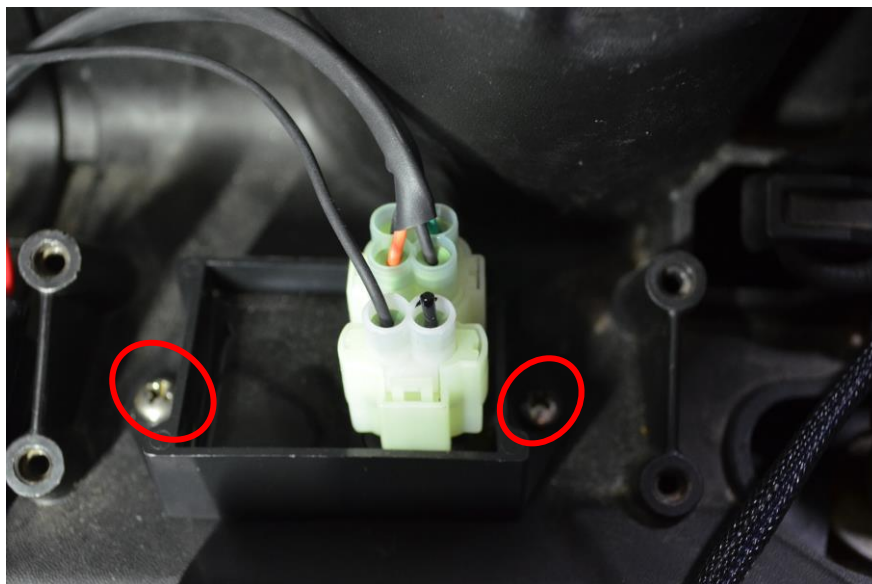

## Step 2: Plug-In and Secure Backup Beeper, and attach leads

- 1) Secure backup beeper using preexisting T-30 bolt.
- 2) Plug the backup beeper into the Sam's Backup beeper harness.
- 3) Remove nut from red terminal under hood with 10mm wrench & secure red ring terminal.

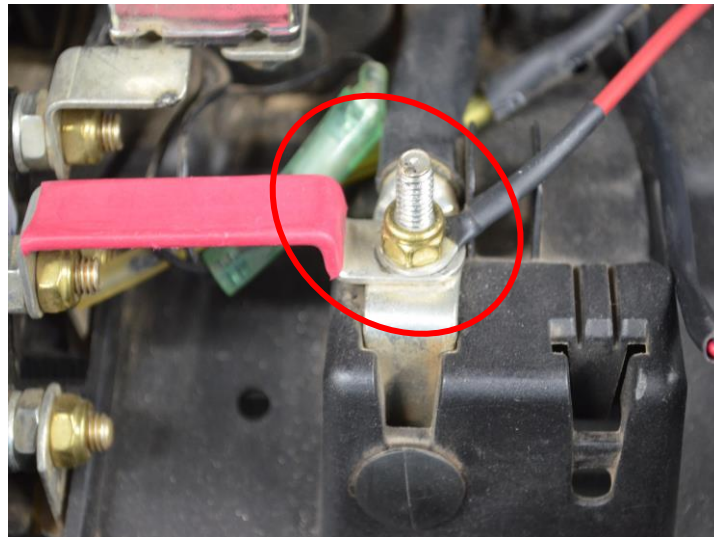

# STRAIGHTLINE PERFORMANCE

## Operation of Reverse Lights

Straightline Performance's Backup Lights are automatic. **NO switches or programming required.** When the vehicle is shifted into reverse, the backup beeper will automatically come on.

Note: If the ignition is turned off while the vehicle is in reverse the backup beeper will remain ON until the ECU enters sleep mode (approximately 30 secs to 2 minutes depending on vehicle and ECU type).

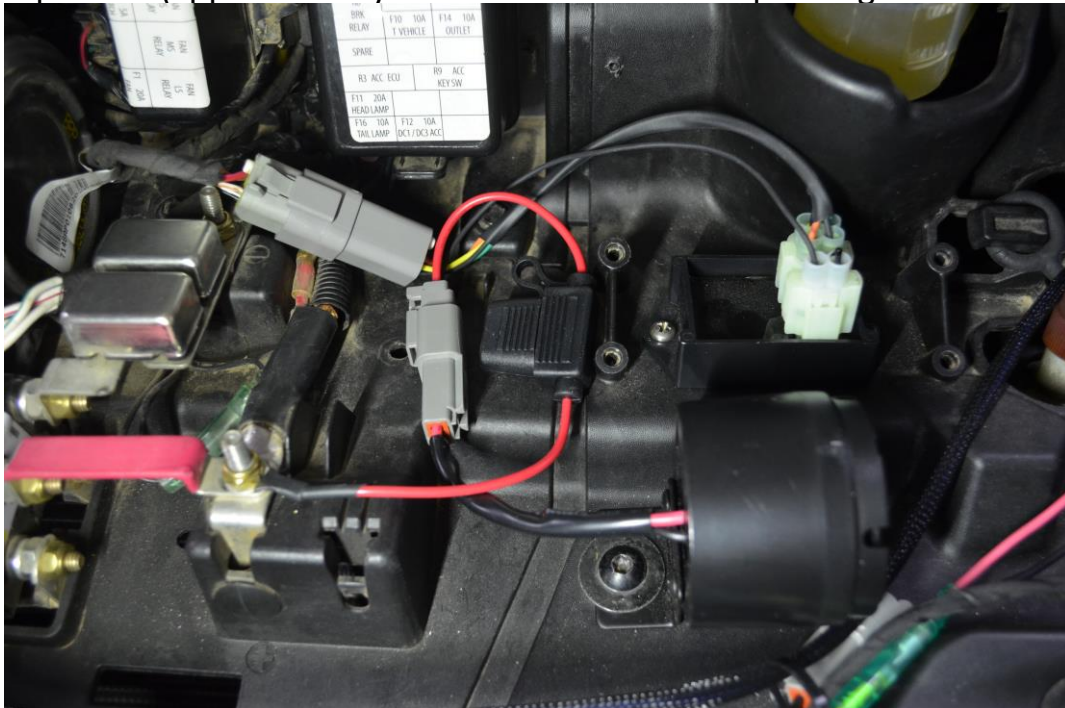

### Bill of Materials, Parts included.

SPI Part number	Description	Qty	In box
IT-238-102	2 screws in baggie	1	
IT-282-109	Controller	1	
IT-282-113	CanAm Diagnostics adapter. 6 pin Deutsch plug on one end, 4 pin plug on the other.	1	
IT-288-107	Fused Deutsch accessories plug. Terminal ring for red wire, black wire goes to backup controller plug.	1	
IT-288-109	Rev Beeper, black housing. 8 inch power lead with Deutch connector.	1	
Sticker	Sticker	2	
Instruction	Installation instructions	1	

Straightline Performance backup lights  
[www.Straightlineperformance.com](http://www.Straightlineperformance.com)

CAN-AM Defender Backup Beeper  
[Tech@straightlineperformance.com](mailto:Tech@straightlineperformance.com)